

CEIL-0613-IP55

Loudspeakers Ceiling loudspeaker

Key points

- Resistant to water projection and dust
- Frameless grille
- Easy to install
- Excellent sound coverage



Resistant to water and dust
IP55 level

Excellent sound coverage
180° broadcast angle



Easy to install

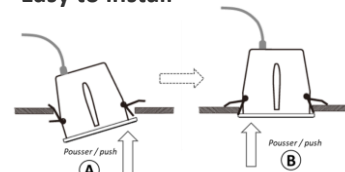

Frameless grille
Discrete integration

More information

This loudspeaker is ideal for flush mounting in ceilings (Ø 12,5cm cutout size / 12cm depth), it is resistant to water projection and dust (IP55) while ensuring a good reproduction of background music and voice messages. Its frameless grille ensure a better and discrete integration. It is easy to install with its 2 metallic legs. Powering is done through supplied cable and selection of 6 / 3W power is available. It is Ideal for false ceiling mounting in humid area, either inside or outside.

FEATURES

Nominal power	6W
100V line power	6 / 3W (through supplied cable)
Frequency range	175 Hz – 20 kHz
SPL (1W / 1m)	91 dB
Directivity (-6dB)	180°
IP level	IP55 (indoor / outdoor usage)
Dimensions	12cm (H) x 12,5cm (Ø cutout)
Material	ABS + metal grille
Color	White
Weight	0.85 Kg

